

Elevation Certificate

Prince William County, VA

1100 MAPLETON ST

Front



Rear



Location Map

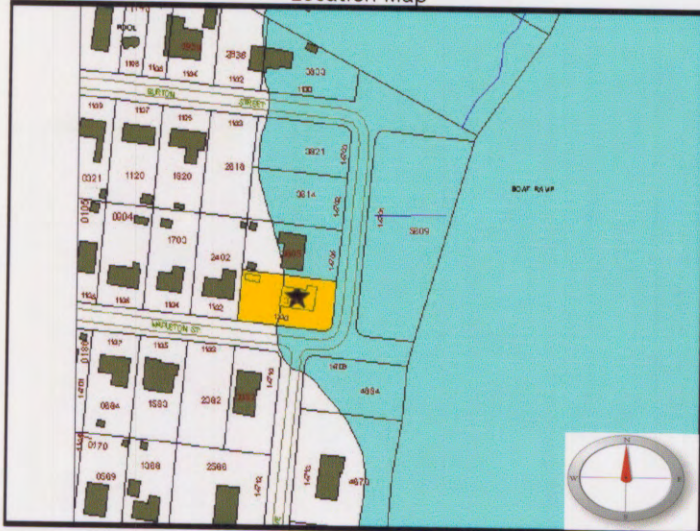

Legend:

- = FEMA Designated 100 year Floodplain
 - = Subject Property
- Not To Scale

Item	Attributes	Value
1	Community Geographic Parcel Identification Number:	8491-05-3797
2	Owner's Name:	CANFIELD JAMES R & BETTY T SURV
3	Street Number:	1100
4	Street Name:	MAPLETON ST
5	City, State:	WOODBIDGE, VA
6	Zip Code:	22191
7	Building Use:	Residential
8	Community, State:	Prince William County, VA
9	FIRM Community Number:	510119
10	FIRM Map Number/Suffix:	51153C 0238D
11	FIRM Index Date:	January 5, 1995
12	FIRM Panel Date:	January 5, 1995
13	FIRM Zone for structure:	AE
14	Elevation Datum:	NGVD 29
15	Base Flood Elevation: (ft)	8.0
16	Source Base Flood Elevation:	FIRM
17	Latitude of House (NAD83): GPS	38°37'58.39160"N
18	Longitude of House (NAD83): GPS	77°14'54.94240"W
19	Elevation Reference Mark (RM):	B115(Reset 1962)
20	Does RM appear on FIRM?	No
21	Top of Bottom Floor: (ft)	12.12
22	Top of Next Higher Floor: (ft)	N/A
23	Top of Garage Floor: (ft)	N/A
24	Lowest Adjacent Grade (LAG): (ft)	8.02
25	Highest Adjacent Grade (HAG): (ft)	9.94
26	Number of flood vents within 1 ft. above adjacent grade:	N/A
27	Total area of all flood vents: (sq.in.)	N/A
28	Building Diagram Number:	1
29	Certifier's Name:	Larry N. Scartz
30	Title:	Certified Land Surveyor
31	License Number:	1000B
32	Name of Survey Company:	Larry N. Scartz, Ltd.
33	Address:	13621 Jefferson Davis Hwy Woodbridge, VA 22191
34	City, State, Zip:	Woodbridge, VA 22191
35	Telephone:	(703) 494-5181
36	Certification:	

Comments:

LAG is deck s...

why it is not renewed?



8/26/99
Date