

Elevation Certificate

Prince William County, VA

13326 BAXTER ST

Front



Rear



Location Map

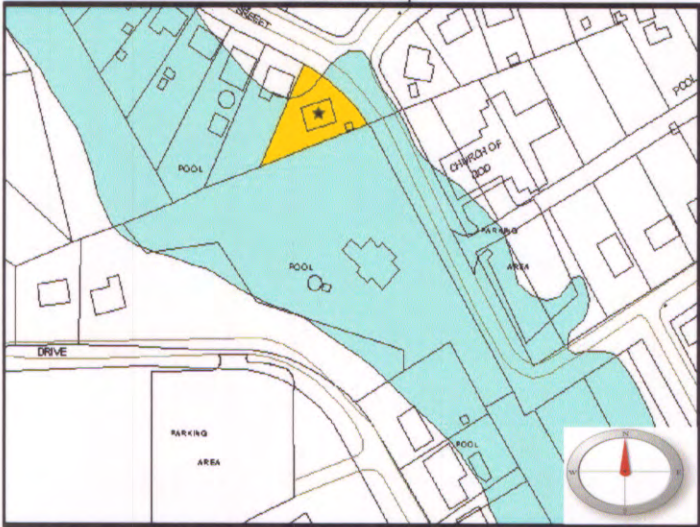

Legend:

- = FEMA Designated 100 year Floodplain
 - = Subject Property
- Not To Scale

| Item | Attributes | Value |
|------|--|---------------------------------|
| 1 | Community Geographic Parcel Identification Number: | 8392-66-2656 |
| 2 | Owner's Name: | BEALL GEORGE E & FRANCES M SURV |
| 3 | Street Number: | 13326 |
| 4 | Street Name: | BAXTER ST |
| 5 | City, State: | WOODBRIDGE, VA |
| 6 | Zip Code: | 22191 |
| 7 | Building Use: | Residential |
| 8 | Community, State: | Prince William County, VA |
| 9 | FIRM Community Number: | 510119 |
| 10 | FIRM Map Number/Suffix: | 51153C 0217 D |
| 11 | FIRM Index Date: | January 5, 1995 |
| 12 | FIRM Panel Date: | January 5, 1995 |
| 13 | FIRM Zone for structure: | AE |
| 14 | Elevation Datum: | NGVD 29 |
| 15 | Base Flood Elevation: (ft) | 66.0± |
| 16 | Source Base Flood Elevation: | FIRM |
| 17 | Latitude of House (NAD83): GPS | 38°39'43.79422" N |
| 18 | Longitude of House (NAD83): GPS | 77°15'45.21482" W |
| 19 | Elevation Reference Mark (RM): | B115 (Reset 1962) |
| 20 | Does RM appear on FIRM? | No |
| 21 | Top of Bottom Floor: (ft) | 65.0± Estimated |
| 22 | Top of Next Higher Floor: (ft) | 73.07 |
| 23 | Top of Garage Floor: (ft) | N/A |
| 24 | Lowest Adjacent Grade (LAG): (ft) | 68.23 |
| 25 | Highest Adjacent Grade (HAG): (ft) | 70.17 |
| 26 | Number of flood vents within 1 ft. above adjacent grade: | N/A |
| 27 | Total area of all flood vents: (sq.in.) | N/A |
| 28 | Building Diagram Number: | 2 |
| 29 | Certifier's Name: | Larry N. Scartz |
| 30 | Title: | Certified Land Surveyor |
| 31 | License Number: | 1000B |
| 32 | Name of Survey Company: | Larry N. Scartz, Ltd. |
| 33 | Address: | 13621 Jefferson Davis Hwy. |
| 34 | City, State, Zip: | Woodbridge, VA 22191 |
| 35 | Telephone: | (703) 494-4181 |
| 36 | CertificateNo: | 2101 |

Comments:



8/13/99
Date