

Elevation Certificate

Prince William County, VA

3976 PEPPERIDGE CT

Front



Rear



Location Map

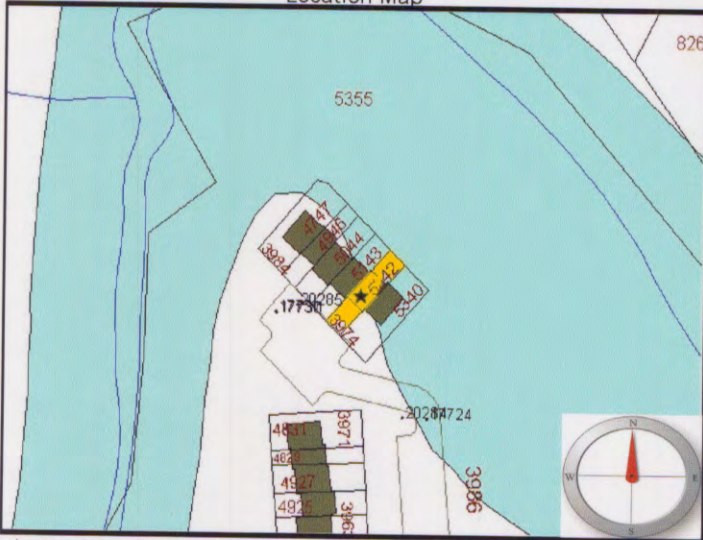

Legend:

- = FEMA Designated 100 year Floodplain
- = Subject Property

Not To Scale

Item	Attributes	Value
1	Community Geographic Parcel Identification Number:	8193-67-5242
2	Owner's Name:	STORER THOMAS & LYNNE L ET AL T C
3	Street Number:	3976
4	Street Name:	PEPPERIDGE CT
5	City, State:	WOODBIDGE, VA
6	Zip Code:	22192
7	Building Use:	Residential
8	Community, State:	Prince William County, VA
9	FIRM Community Number:	510119
10	FIRM Map Number/Suffix:	51153C0204D
11	FIRM Index Date:	January 5, 1995
12	FIRM Panel Date:	January 5, 1995
13	FIRM Zone for structure:	A
14	Elevation Datum:	NGVD 29
15	Base Flood Elevation: (ft)	Unknown
16	Source Base Flood Elevation:	FIRM
17	Latitude of House (NAD83): GPS	38°41'33.27163"N
18	Longitude of House (NAD83): GPS	77°19'51.82055"W
19	Elevation Reference Mark (RM):	PW066
20	Does RM appear on FIRM?	NO
21	Top of Bottom Floor: (ft)	177.04
22	Top of Next Higher Floor: (ft)	185.85
23	Top of Garage Floor: (ft)	N/A
24	Lowest Adjacent Grade (LAG): (ft)	176.03
25	Highest Adjacent Grade (HAG): (ft)	183.88
26	Number of flood vents within 1 ft. above adjacent grade:	N/A
27	Total area of all flood vents: (sq.in.)	N/A
28	Building Diagram Number:	1
29	Certifier's Name:	Larry N. Scartz
30	Title:	Certified Land Surveyor
31	License Number:	1000B
32	Name of Survey Company:	Larry N. Scartz, Ltd.
33	Address:	13621 Jefferson Davis Hwy.
34	City, State, Zip:	Woodbridge, VA 22191
35	Telephone:	(703) 494-4181
36	CertificateNo:	139

Comments:



11/6/99
Date