

Elevation Certificate

Prince William County, VA

7702 AMHERST DR

Front



Rear



Location Map

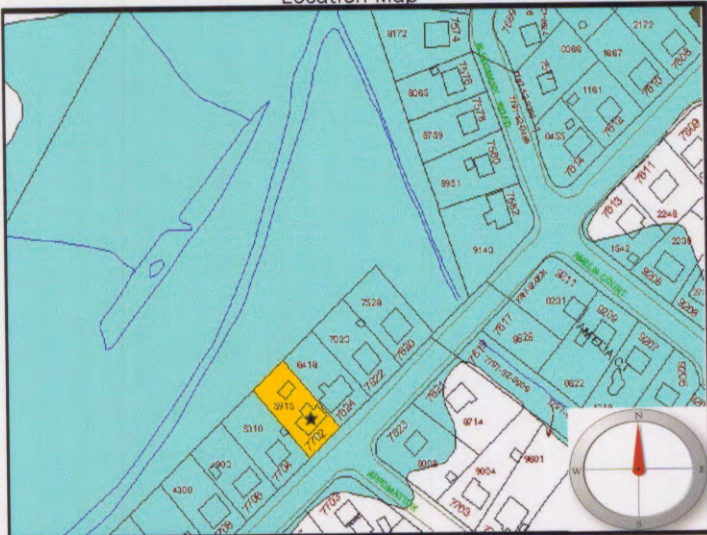

Legend:

- = FEMA Designated 100 year Floodplain
- = Subject Propert

Not To Scale

Item	Attributes	Value
1	Community Geographic Parcel Identification Number:	7797.42-5915
2	Owner's Name:	JEMIELITY KENNETH & J M TULLY
3	Street Number:	7702
4	Street Name:	AMHERST DR
5	City, State:	MANASSAS, VA
6	Zip Code:	20111
7	Building Use:	Residential
8	Community, State:	Prince William County, VA
9	FIRM Community Number:	510119
10	FIRM Map Number/Suffix:	51153C 0111D
11	FIRM Index Date:	January 5, 1995
12	FIRM Panel Date:	January 5, 1995
13	FIRM Zone for structure:	AE
14	Elevation Datum:	NGVD 29
15	Base Flood Elevation: (ft)	165.6±
16	Source Base Flood Elevation:	FIRM
17	Latitude of House (NAD83): GPS	38°47'21.38125" N
18	Longitude of House (NAD83): GPS	77°28'36.08466" W
19	Elevation Reference Mark (RM):	HV2761
20	Does RM appear on FIRM?	No
21	Top of Bottom Floor: (ft)	161.46
22	Top of Next Higher Floor: (ft)	169.33
23	Top of Garage Floor: (ft)	N/A
24	Lowest Adjacent Grade (LAG): (ft)	162.76
25	Highest Adjacent Grade (HAG): (ft)	166.91
26	Number of flood vents within 1 ft. above adjacent grade:	N/A
27	Total area of all flood vents: (sq.in.)	N/A
28	Building Diagram Number:	2
29	Certifier's Name:	Larry N. Scartz
30	Title:	Certified Land Surveyor
31	License Number:	1000B
32	Name of Survey Company:	Larry N. Scartz, Ltd.
33	Address:	13621 Jefferson Davis Hwy.
34	City, State, Zip:	Woodbridge, VA 22191
35	Telephone:	(703) 494-4181
36	CertificateNo:	2074

Comments:



9/10/99

Date